

Medium Level Order Pickers

EOC 100

1000 kg medium level order picker.
Providing picking heights up to 9m. Combining great performance with high levels of safety.

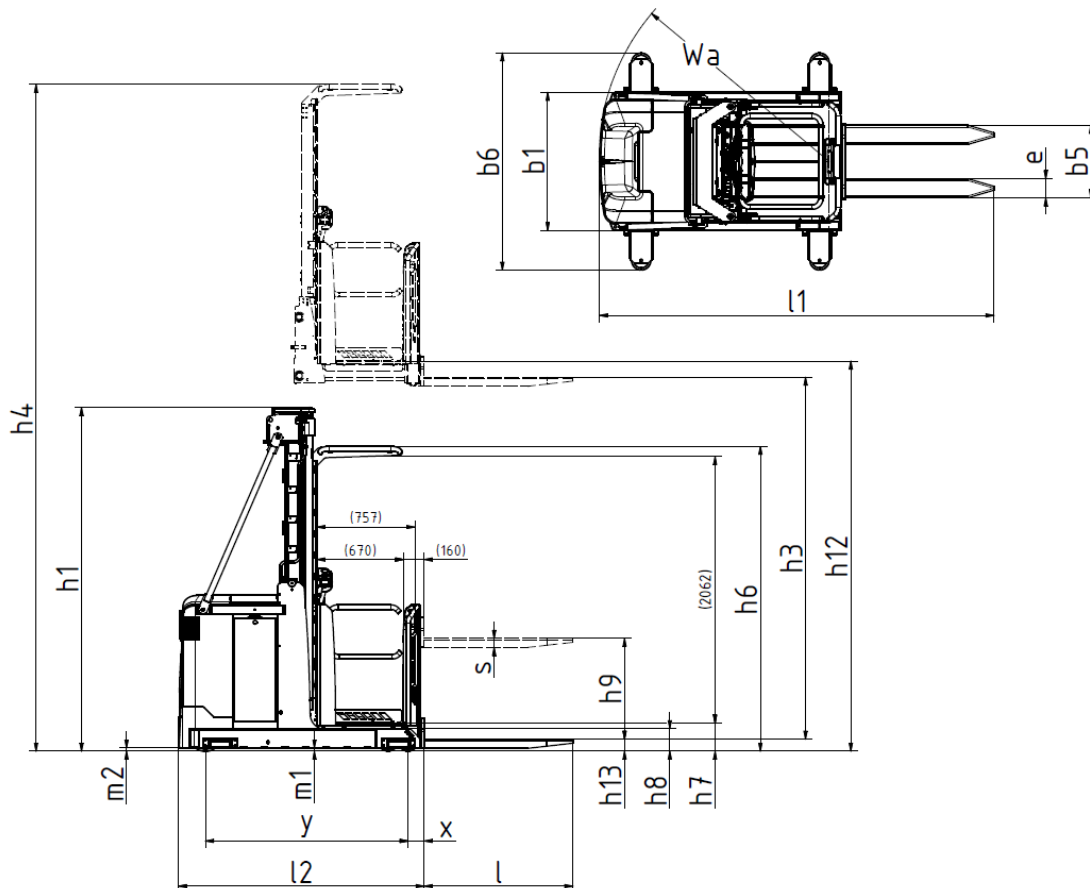

Mast type	Lift height H / h12	Height of mast lowered h1	Max mast height h4
Standard/Duplex	3600	2392	5740
	4000	2592	6140
	4400	2792	6540
	4700	2942	6840
	5000	3092	7140
	5400	3292	7540
	5800	3492	7940
	6200	3692	8340
	6600	3892	8740
	7000	4092	9140
7400	4292	9540	
Triplex			

Distinguishing mark	1.2	Manufacturer's type designation		EOC 100		
	1.3	Drive: electric (battery or mains), diesel, petrol, fuel gas		Electric		
	1.4	Operator type: hand, pedestrian, standing, seated, order-picker		Order picker		
	1.5	Load capacity/rated load	Q	t	1	
	1.6	Load centre distance	c	mm	400-600	
	1.8	Load distance, centre of load axle to fork	X		125	
	1.9	Wheelbase	y	mm	1568	
Weight	2.1	Service weight incl battery		kg	1850 kg + 96 x h12 (m)	
	2.2	Axle loadings with nominal load & maximum battery weight, drive / load side		kg	1110/2800	
	2.3	Axle loadings without load & with maximum battery weight, drive / load side		kg	1660/1250	
Tyres, chassis	3.1	Tyres			Vulcollan	
	3.2	Tyre size, drive side		mm	250x105	
	3.3	Tyre size, load side		mm	150x55	
	3.5	Wheels, number front/rear (drive side/load side, x = driven wheels)			1x/8	
	3.6	Track, drive side	b10	mm	n/a	
	3.7	Track, load side	b11	mm	806/906/1006	
	Dimensions	4.2	Height, mast lowered		h1	mm
4.4		Lift height H = h13+h3		H	mm	3285-7185 (without h9)
4.5		Height, mast extended		h4	mm	h12+2140
4.7		Height of overhead guard (cabin)		h6	mm	2356
4.8		Seat height/stand height		h7	mm	215-h12
4.10		Height of wheel arms		h8	mm	175
4.11		Additional lift		h9	mm	775
4.14		Stand height, elevated		h12	mm	3600-7400
4.15		Height lowered		h13	mm	90
4.19		Overall length		l1	mm	3055
4.20		Length to face of forks		l2	mm	1903
4.21		Overall width		b1	mm	970/1070/1170
4.22		Fork dimensions		s/e/l	mm	70/147/1150
4.24		Width of fork carriage		b3	mm	560
4.25		Width over forks, min/max		b5	mm	450 - 800
4.27		Width across guide rollers		b6	mm	1148-1814
4.32		Ground clearance, centre of wheelbase		m2	mm	25
4.34	Aisle width for pallet 800 x 1200, lengthwise		Ast	mm	Platform or load width + clearance	
4.35	Turning radius		Wa	mm	1790	
Performance data	5.1	Travel speed, with/without load		km/h	11/11	
	5.1.1	Travel speed with/without load, backwards		km/h	11/11	
	5.2	Lift speed, with/without load		m/s	0,21/0,32	
	5.3	Lowering speed, with/without load		m/s	0,4/0,4	
	5.8	Max gradeability, with / without load, 5 min rating		%	7,1	
	5.9	Acceleration time 0-10 m, with/without load		s	6,3/5,8	
	5.10.1	Parking brake: electric, hydraulic			Electric	
Electric	6.1	Drive motor, rating S2 60 min		kW	2,7	
	6.2	Lift motor		kW	8 (20%)	
	6.3	Battery according to DIN 43531/35/36		A, B, C	BS	
	6.4	Battery voltage / Battery capacity		V/Ah	24/560-775	
	6.5	Battery weight		kg	Min 500 Max 700	
	6.6	Power consumption according to VDI cycle		kWh/h		
Additional data	8.1	Speed regulation			AC traction	
	10.7	Noise level at operator's ear, according to EN 12 053		db(A)	66	